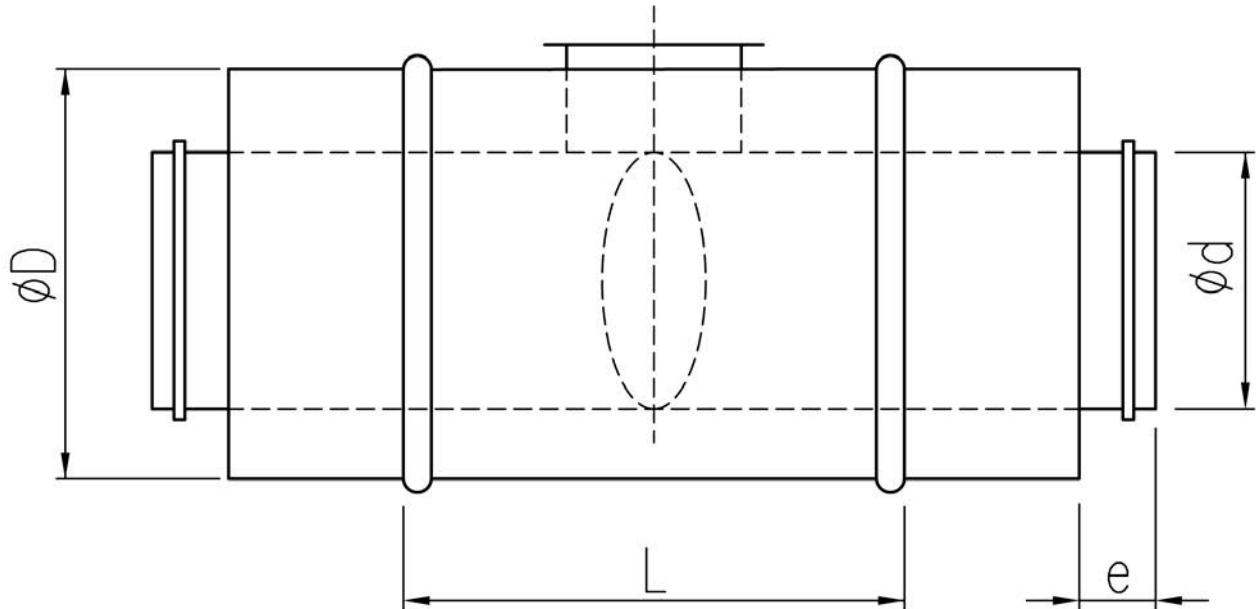

DESCRIPTION

The DSLI damper can be used in places where full tightness is not required. Position of the damper is controlled by a screw. The element is insulated with mineral wool.

DIMENSIONS

Dimensions [mm]			Weight [kg]
$\varnothing d$	$\varnothing D$	L	
80	112	130	0.5
100	132	130	0.7
125	157	130	0.8
160	192	130	1.0
200	232	130	1.4
250	280	168	1.8

Diameter $\varnothing d$ [mm]	Tolerance e [mm]
80-224	36
250-355	55