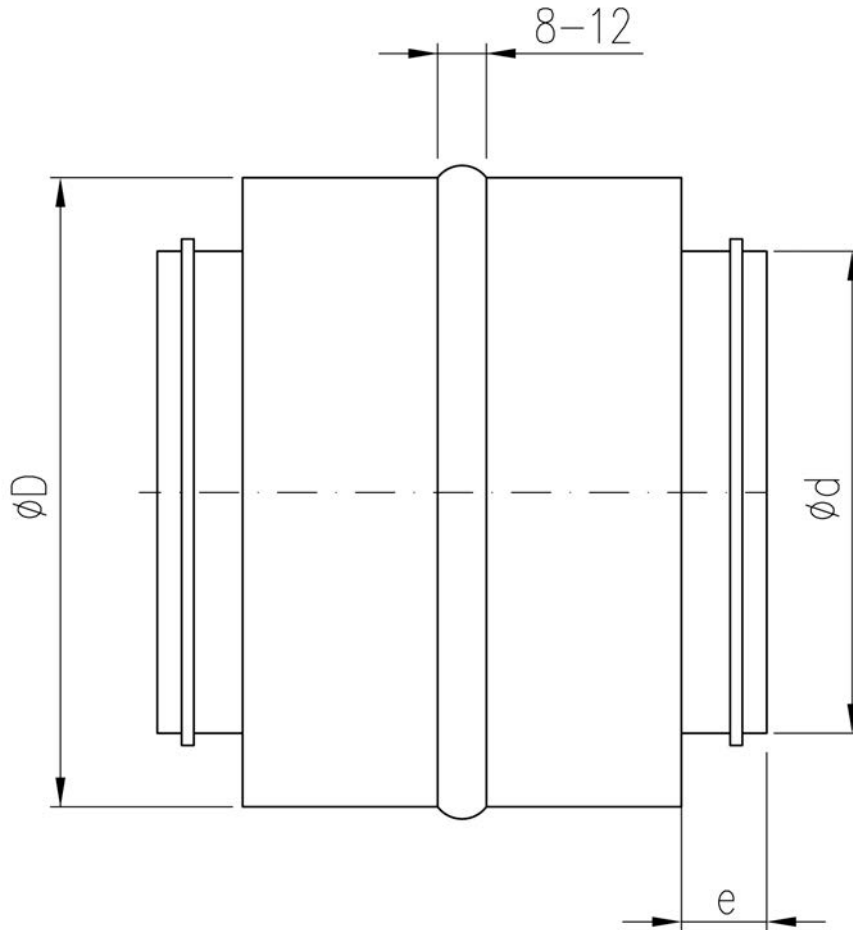

DESCRIPTION

The NPLI nipple connector is a coupling element with EPDM gasket. It is used for joining SRI ducts. The element is insulated with mineral wool – 16mm thick.

DIMENSIONS

Dimensions [mm]		Weight [kg]
Ød	ØD	
80	112	0.3
100	132	0.3
125	157	0.4
160	192	0.5
200	232	0.6
250	280	1.1

Diameter Ød [mm]	Tolerance e [mm]
80-224	36
250-355	55