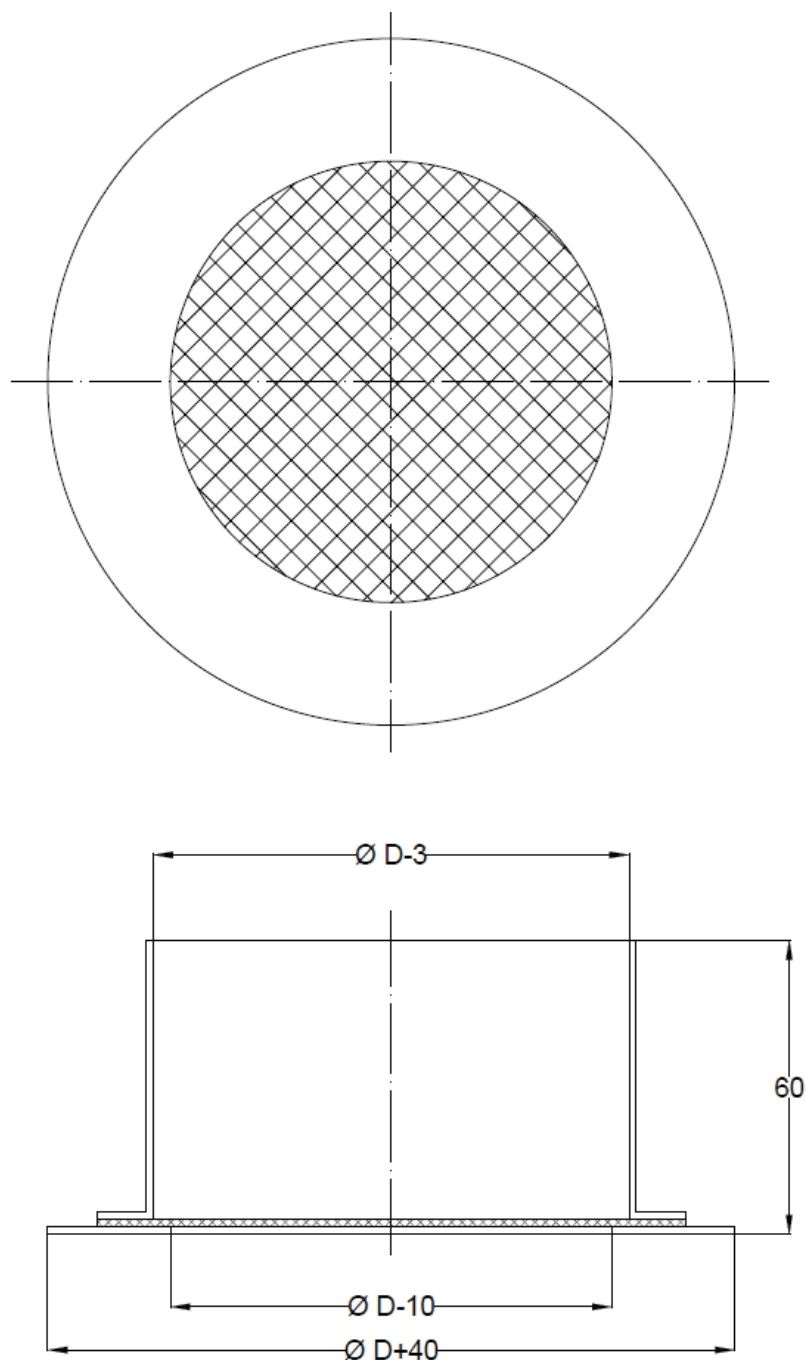

Description

Air grilles KS are designed for applications in the low- and medium-pressure ventilation systems. They can be mounted as a supply or exhaust grilles, or as a cover at the end of the round duct.

Material

In standard execution the grilles are made of galvanized steel. On order, it is possible to make it of stainless steel or to varnish in any RAL colour.

Dimensions

Diameter of the air duct D [mm]
100
125
160
200
250
315
400

Other dimensions available on order.

Cover surface

Cover surface of grilles are available in three different executions:

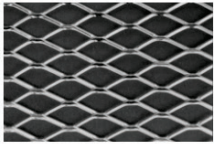

KS1

Expanded wire mesh 4.5 x 9
(clearance 56%)

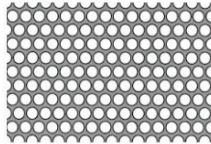

KS2

Circular mesh
(clearance 58%)



KS3

Rectangular mesh
(clearance 51%)

Marking

While making the order, it is necessary to provide the information according to the below-mentioned method:

KS<W> - <D> - <P><RAL>

<W> Cover type

- **1 – Expanded wire mesh 4.5 x 9, clearance 56% (default)**
- 2 – Circular mesh, clearance 58%
- 3 – Rectangular mesh, clearance 51%

<D> Diameter of air duct

<P> Finishing

- **SO - Galvanized steel (default)**
- SL - Varnished
- SN - Stainless steel

<RAL> Colour according to RAL (**default: RAL9010**)

Example:

KS2 – 250 – SL9008